



BANNING PRESSURE GAUGE PM580



BANNING

DESCRIPTION

PM580 Intelligent digital pressure gauge is a high-precision intelligent digital pressure gauge with a built-in high-precision pressure sensor, which can accurately display the pressure in real time, and has the characteristics of high accuracy and long-term stability.

CHARACTERISTICS

- Four-digit LCD screen displays pressure in real time, which is convenient for customers to observe
- Multiple pressure unit switching, clearing, backlight, power on and off functions
- Battery-powered for up to 24 months
- Built-in high-precision pressure sensor

PERFORMANCE

Parameter	PM580
Measuring range	-100kPa... 0 ~ 10kPa... 100MPa
Pressure type	Gauge, Absolute, Sealed
Accuracy class	0.5%FS
Backlight color	Blue backlight
Operating temperature	-10 ~ 70°C
Compensation temperature	0 ~ 60°C
Electrical protection	Anti-electromagnetic interference design
Sampling frequency	5 times / second
Overload pressure	150%FS
Long-term stability	± 0.2% FS / year (typical)
Battery powered	Two AA batteries
Texture	Housing stainless steel, isolation diaphragm 316L
Media compatible	Various media compatible with 316 stainless steel

APPLICATION

- Machinery & Electronics
- Instrumentation accessory
- Pressure laboratory
- Engineering machinery automation

EXTERNAL STRUCTURE

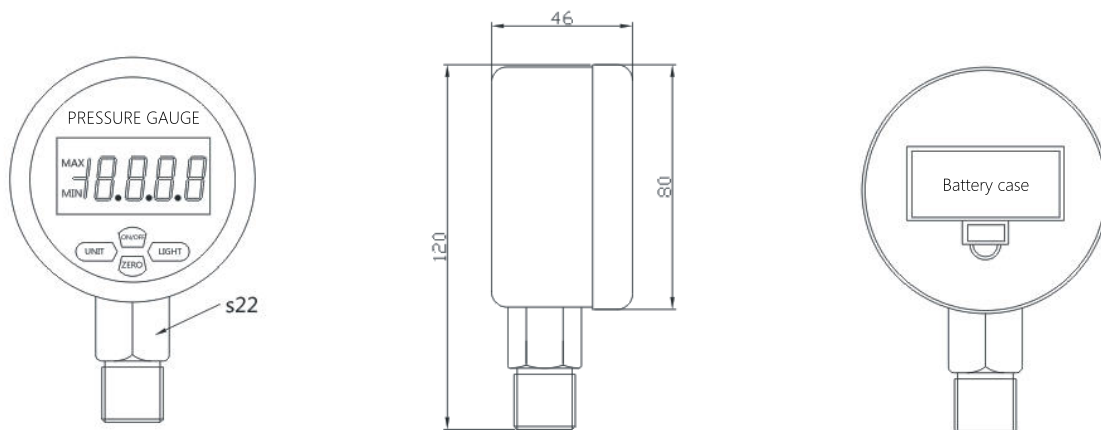

THREADED INTERFACE

Type	C1: M20× 1.5	C3: G1/4	C7: NPT1/2
Dimensions unit: mm			

NOTE: Conventional threads are M20 × 1.5, G1 / 4, G1 / 2, M14 × 1.5, NPT1 / 4, NPT1 / 2. Special thread batches can be customized.

NOMENCLATURE

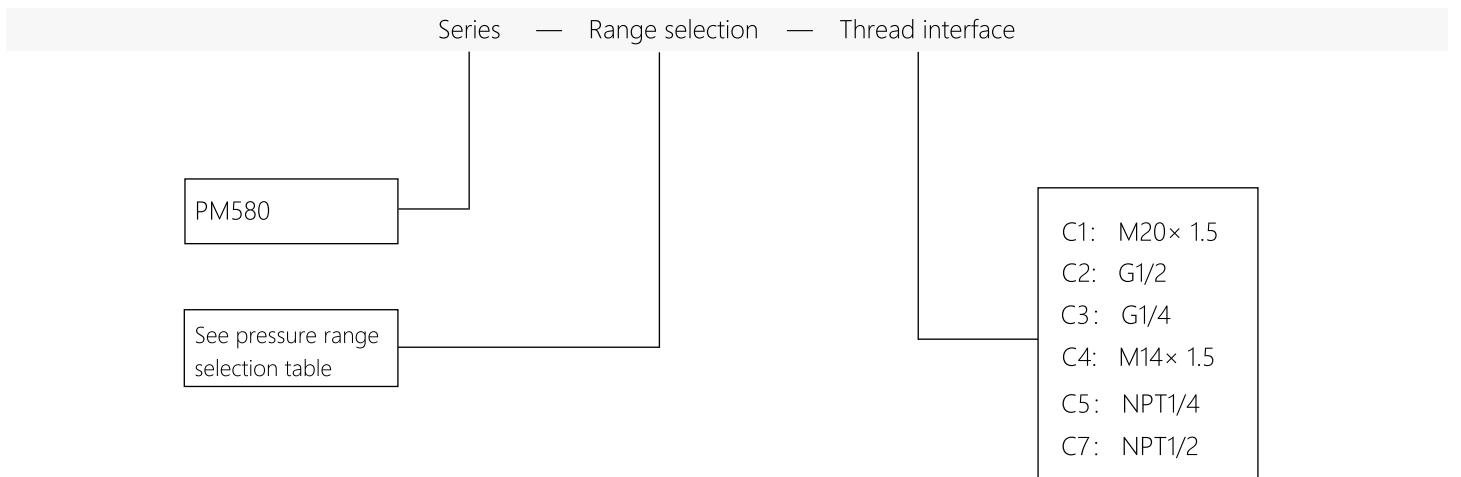

FOR EXAMPLE: PM580-250KG-C1

It means PM580 series, measuring range is 0 ~ 250kPa, gauge pressure, thread interface is M20 × 1.5.

PRESSURE RANGE SELECTION TABLE

Range code	Pressure type	Measuring range	Overload pressure	Burst pressure	Remark
N1K	G	-100kPa ~ 0	200%FS	400%FS	
NP100K	G	± 100kPa	200%FS	500%FS	
N4K	G	-100 ~ 160kPa	200%FS	500%FS	
N5K	G	-100 ~ 250kPa	200%FS	500%FS	
N6K	G	-100 ~ 400kPa	200%FS	500%FS	
N7K	G	-100 ~ 600kPa	200%FS	500%FS	
N8M	G	-0.1 ~ 1MPa	200%FS	500%FS	
N9M	G	-0.1 ~ 1.6MPa	200%FS	500%FS	
5KG	G	0 ~ 5kPa	200%FS	500%FS	
10KG	G	0 ~ 10kPa	300%FS	600%FS	
16KG	G	0 ~ 16kPa	300%FS	600%FS	
25KG	G	0 ~ 25kPa	300%FS	600%FS	
40KG	G	0 ~ 40kPa	300%FS	600%FS	
60KG	G	0 ~ 60kPa	300%FS	600%FS	
100KG	G	0 ~ 100kPa	200%FS	500%FS	
160KG	G	0 ~ 160kPa	200%FS	500%FS	
250KG	G	0 ~ 250kPa	200%FS	500%FS	
400KG	G	0 ~ 400kPa	200%FS	500%FS	
600KG	G	0 ~ 600kPa	200%FS	500%FS	
1MG	G	0 ~ 1MPa	200%FS	500%FS	
1.6MS	S	0 ~ 1.6MPa	200%FS	500%FS	
2.5MS	S	0 ~ 2.5MPa	200%FS	500%FS	
4MS	S	0 ~ 4MPa	200%FS	400%FS	
6MS	S	0 ~ 6MPa	200%FS	400%FS	
10MS	S	0 ~ 10MPa	200%FS	400%FS	
16MS	S	0 ~ 16MPa	200%FS	400%FS	
25MS	S	0 ~ 25MPa	150%FS	300%FS	
40MS	S	0 ~ 40MPa	150%FS	300%FS	
60MS	S	0 ~ 60MPa	150%FS	300%FS	
100MS	S	0 ~ 100MPa	150%FS	300%FS	

NOTE: G gauge pressure, S seal pressure

DISCLAIMER

⚠ Warning

LIFE OR PROPERTY RISK

- Please ensure that this product has been designed as part of whole system and already considered related risks, make sure the product has the correct ratings and is designed based on the entire system. It must not be used when applications related to serious life or property damage risks.

Failure to follow this instruction can result in death or serious injury.

⚠ Warning

PERSONAL INJURY

- DO NOT USE these products as safety or emergency stop devices or in any other application where failure of the product could result in personal injury.

Failure to follow this instruction can result in death or serious injury.

⚠ Warning

MISUSE OF DOCUMENTATION

- The information presented in this product sheet is for reference only. Do not use this document as a product installation guide.
- Complete installation, operation, and maintenance information is provided in the instructions supplied with each product.

Failure to follow this instruction can result in death or serious injury.

Warranty/Remedy

Banning warrants goods of its manufacture as being free of defective materials and faulty workmanship during the applicable warranty period. Banning's standard product warranty applies unless agreed to otherwise by Banning in writing; please refer to your order acknowledgment or consult your local sales office for specific warranty details. If warranted goods are returned to Banning during the period of coverage, Banning will repair or replace, at its option, without charge those items that Banning, in its sole discretion, finds defective. **The foregoing is buyer's sole remedy and is in lieu of all other warranties, expressed or implied, including those of merchantability and fitness for a particular purpose. In no event shall Banning be liable for consequential special, or indirect damages.**

While Banning may provide application assistance personally, through our literature and the Banning web site, it is buyer's sole responsibility to determine the suitability of the product in the application.

Specifications may change without notice. The information we supply is believed to be accurate and reliable as of this writing. However, Banning assumes no responsibility for its use.

SALES & SERVICE

Banning serves its clients through a worldwide network of sales offices, agents and distributors. For application assistance specifications, prices or names with the nearest authorized dealer, please contact your sales specialist or contact us directly:

Banning (Nanjing) Sensing Technology Co., Ltd.

Nanjing, Daqiao rth road #48 Huadongmall, building C3-1, 12th floor

TEL: 400-7181-886

TEL: 025-5829 5589



WeChat



Invoice

Official Website: www.banningsensor.com

Service Hotline : 400-7181-886

Official mailbox: sales@banningsensor.com

© 2019Banning (Nanjing) Sensing Technology Co., Ltd.

INTEGRITY
INTERNATIONAL
INNOVATION

BANNING